

User Manual

Tankless Reverse Osmosis System

Model: E600WA

Read and Save the Instructions

V2

Installation Video



Search “SMONET E600WA” on Youtube



Customer Service

All SMONET products come with lifetime support, feel free to contact us if you have any questions.



Email: waterfilter@smonet.com

Toll-free: 1-888-666-9168

Mon-Sun: 5:00 PM-2:00 AM(PST)

WhatsApp/FaceTime ID: +86 158 1749 7067

WeChat ID: B997520270

Website: www.smonet.com



WhatsApp



WeChat

Contents

Safety Notice	01
In the Box	02
Product Overview	03
Sample Connection	04
Tips Before Installation	05
Installation	06
Install the Feeder Water Adapter	06
Install the Filters	07
Install the RO Faucet	08
Install the Drain Saddle	09
Connect the Tubes	10
Connect the Inlet Water Tube	10
Connect the Filtered Water Tube	11
Connect the Waste Water Tube	12
Start up the System	13
Indicators & Display	14
Filter Life Indicators	14
Inlet Water Quality Indicator	14
RO Faucet Display	15
About Error Codes	15
Filter Replacement Guide	16
Troubleshooting	18
Specifications	19

Safety Notice



1. Only use the power adapter with the rated voltage.
2. For long-time storage, shut off the feed water adapter and unplug the power adapter.
3. After a long period of non-use, follow the instructions for the first use.
4. In case of leaks, failures, or other abnormalities, disconnect the power and contact us.
5. To prevent damage or leaks, do not disassemble the machine.
6. Only use municipal water as the source.

Required Tools (Not included)

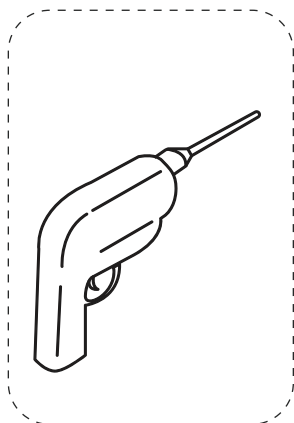

Variable speed drill

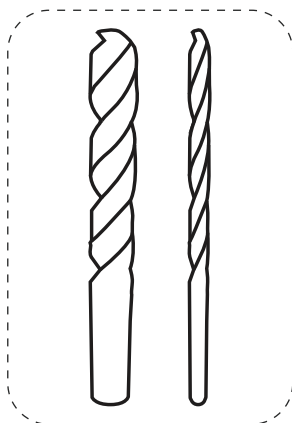

Drill bit:
1/4" (for drainpipe)
1" (for faucet hole)

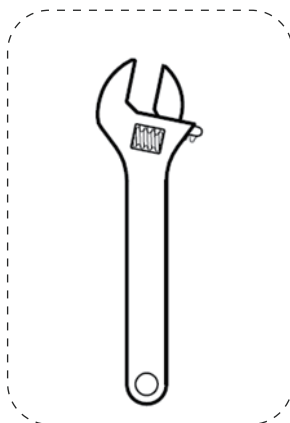

Adjustable Wrench

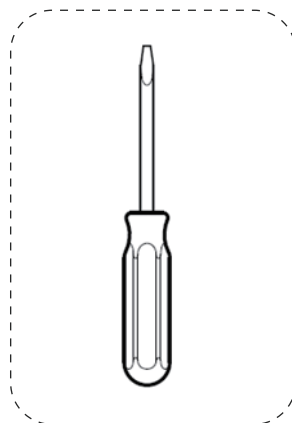

Phillips Screwdriver

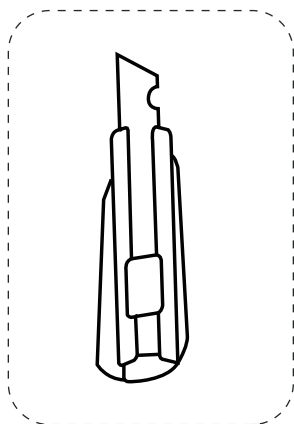

Utility knife

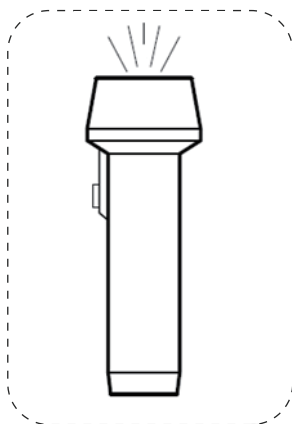

Flashlight

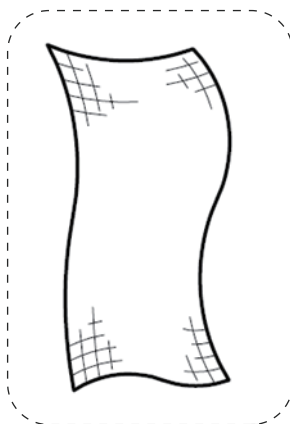

Towel

In the Box

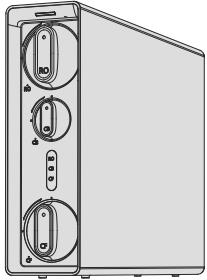

System Housing
with Filters*1

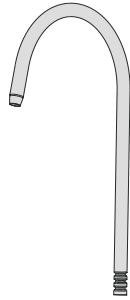

Smart Faucet
Spout*1

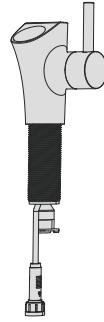

Faucet Body*1

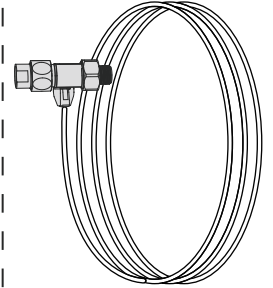

Feed Water
Adapter*1 Set

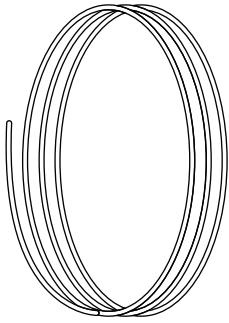

1/4" Filtered
Water Tube*1

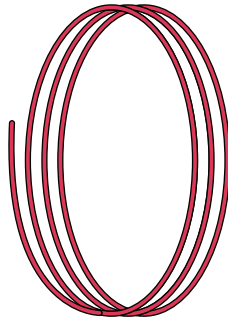

1/4" Waste
Water Tube*1

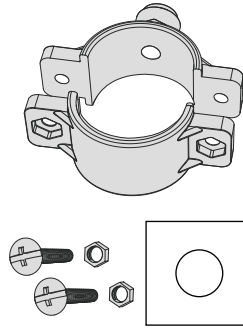

Drain Saddle*1 Set

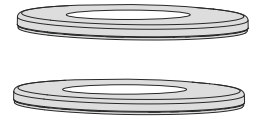

Gasket*2



Lock Clip*5

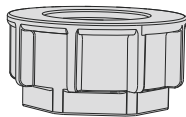

Nut*1

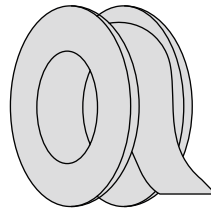

Teflon Tape*2

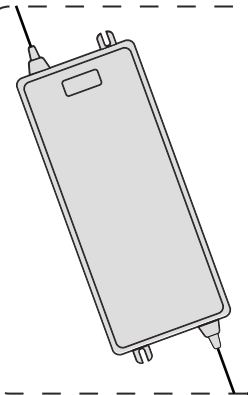

Power Adapter*1

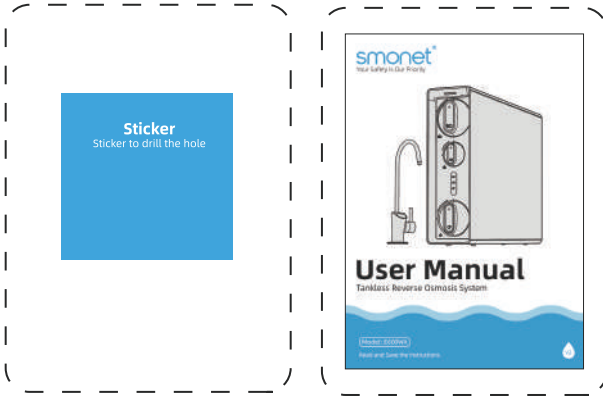

Hole Size Sticker*1

User Manual*1

Product Overview

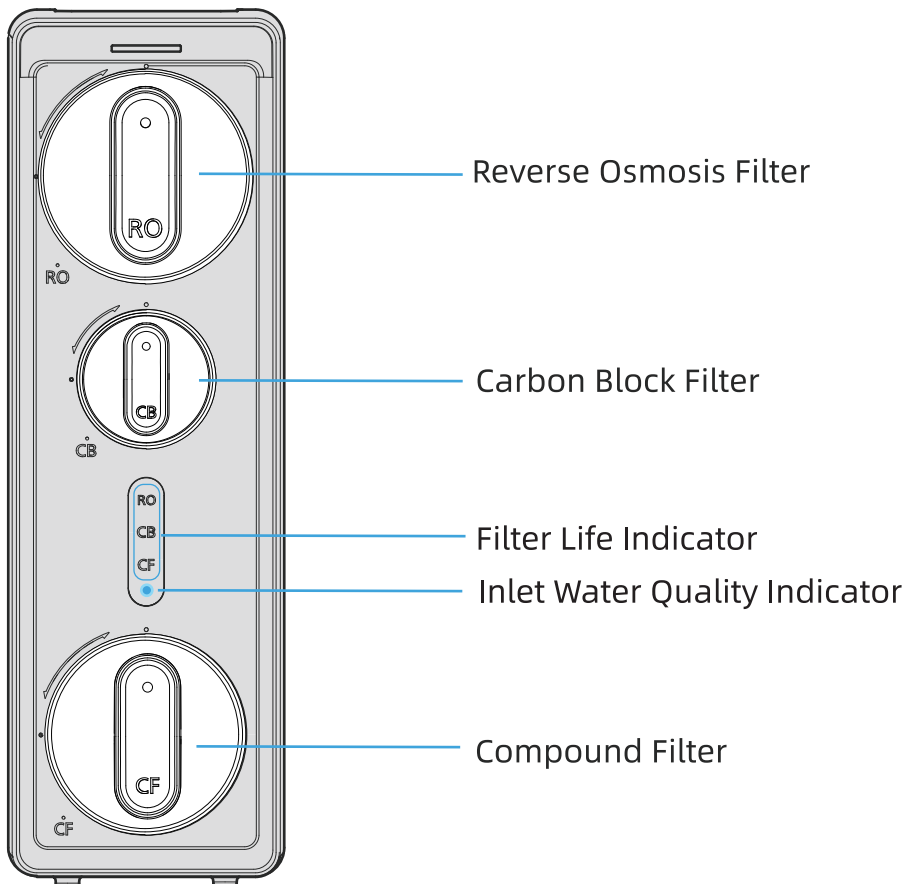

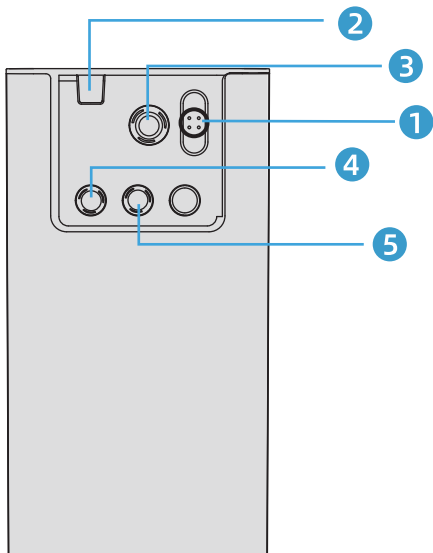

- 1. Smart Faucet Port
- 2. Power Port
- 3. Inlet Water Port
- 4. Filtered Water Outlet
- 5. Waste Water Outlet

Sample Connection

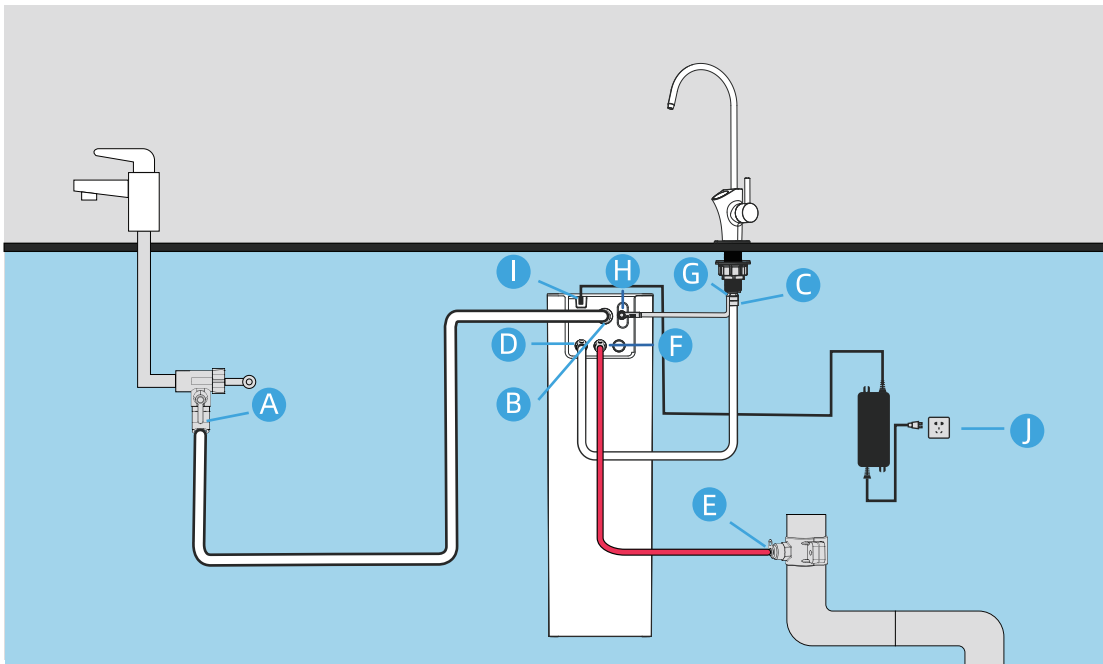

A→B, From Feed Water Adapter to Inlet Water Port

C→D, From RO Faucet to Filtered Water Outlet

E→F, From Drain Saddle to Waste Water Outlet

G→H, From Faucet Power Cord to Faucet Port

I→J, From Power Port to Power Socket

Tips Before Installation



Attention: Don't pull out the tube directly. This will damage the joint and cause leakage.

To Connect

1. Insert the tube

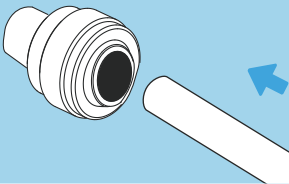

2. Gently pull the plastic ring of the port/quick connector to leave a slot.

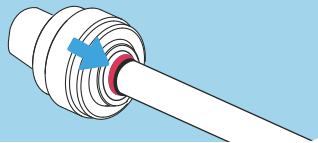

3. Insert the blue lock clip to secure the connection.

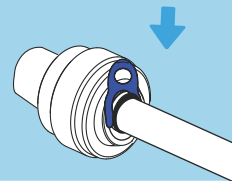

To Disconnect

1. Remove the blue lock clip from the joint.

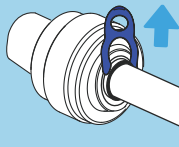

2. Press the plastic ring of the port.

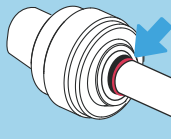

3. Gently pull out the tube from the port or quick connector.

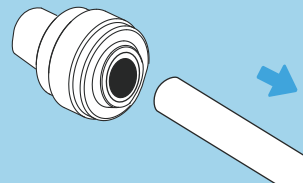



Install the Feed Water Adapter (3/8" or 1/2")

1. Shut off the cold water supply valve under the sink. Turn on the kitchen faucet to release the water pressure.
2. Disconnect the cold water pipe of the kitchen faucet from the cold water supply valve.
3. To prevent water leakage, please apply several rounds of Teflon tape to the cold water supply valve and the threaded end of the feed water adapter.
4. Twist the feed water adapter onto the cold water supply valve and tighten it with a wrench.

Note: If the cold water pipe is 1/2", unscrew the two converters from the feed water adapter, and then implement Step 4.

5. Twist the cold water pipe onto the feed water adapter and tighten it with a wrench.

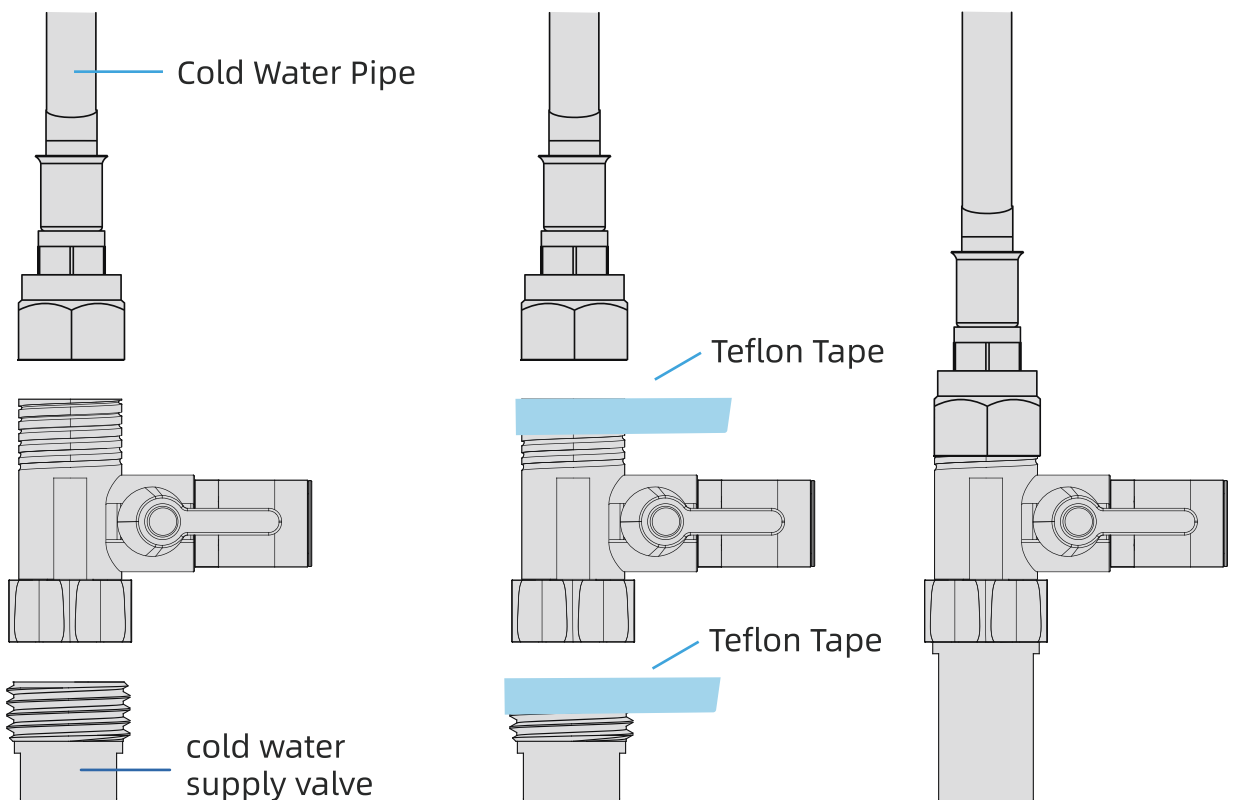

Install the Filters

1. Take out the filters and remove the wrappings from the top of each filter.
2. Insert each filter horizontally into its corresponding slot (**RO filter: top**, **CB filter: middle**, **CF filter: bottom**).
3. Clockwise twist the filter with a little force for 90 degrees, until the top circle is aligned with the solid circle on the top of the slot.

Note: To avoid water leakage, the filters should fit snugly into the system.

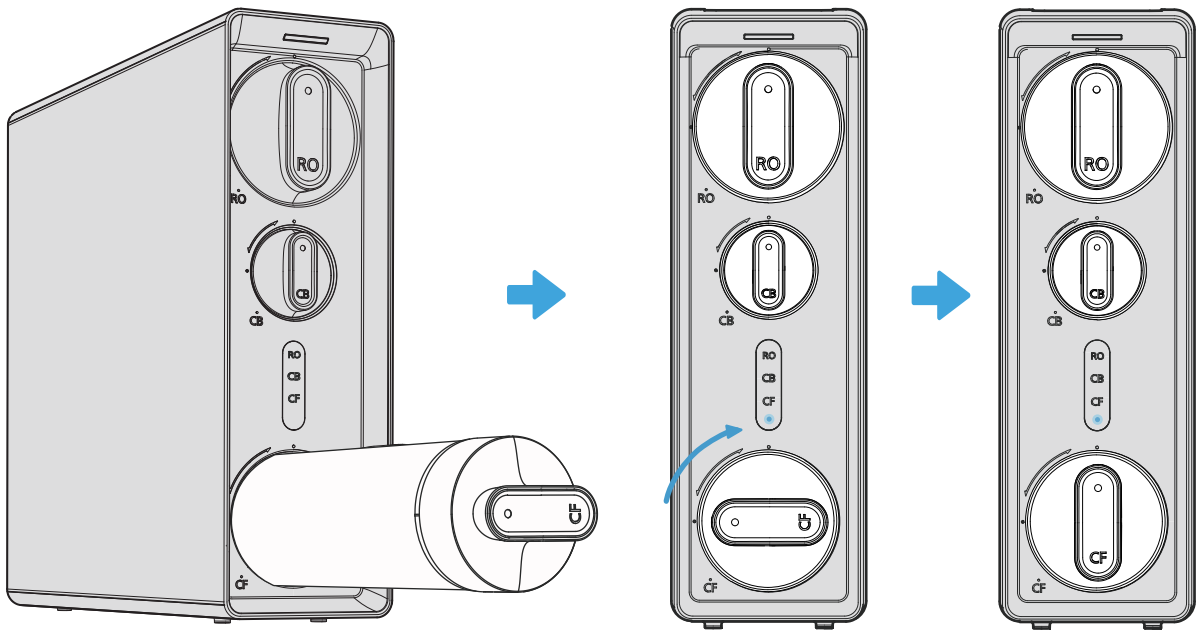

Install the RO Faucet

Note: If your kitchen sink or countertop does not have an existing hole, you will need to drill one (hole diameter: 1 inch). A reference sticker is provided to help you drill the hole.

1. Insert the faucet spout into the faucet body.
2. Slip on the gasket.
3. Insert the faucet into the hole on the kitchen or countertop.
4. Under the sink, slip on and tighten the gasket and nut.

Note: Slip on the parts in the order shown in the picture.

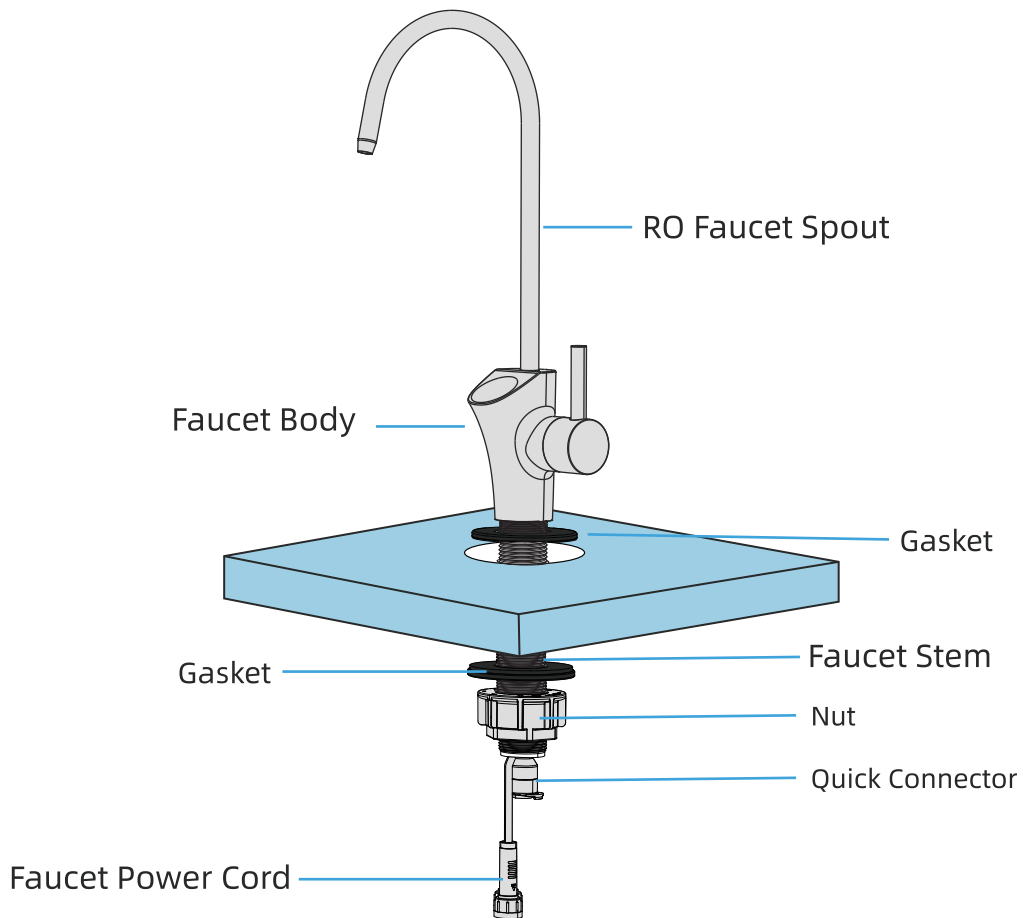

Install the Drain Saddle

1. Paste the foam seal provided to the inside of the drain saddle. Make sure the hole of foam seal is aligned with the hole of drain saddle. Choose a spot on the vertical drainpipe for installing the drain saddle.
2. Drill a 1/4 inch hole in the drainpipe. Be sure not to penetrate the opposite side of
3. Slip the drain saddle on one end of the red tube, and insert the red tube into the drilled hole on the drainpipe.
4. Secure the drain saddle on the drainpipe by tightening the screws and nuts while leaving the tube in the hole.
5. Secure the tube in place with a lock clip.

1 Drainpipe

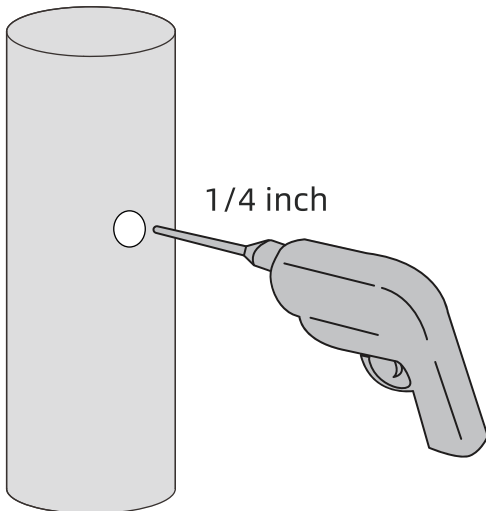

2

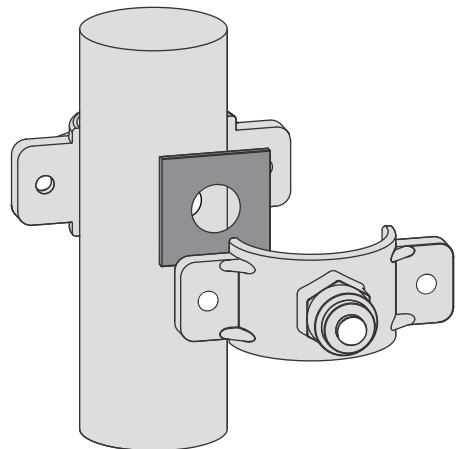

3

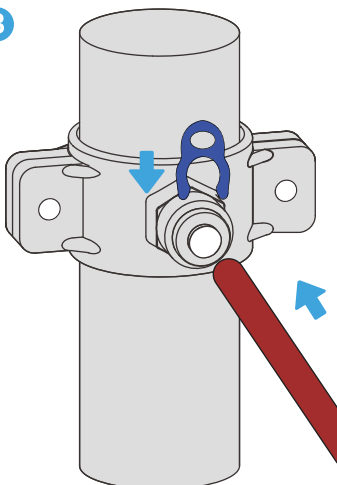

4

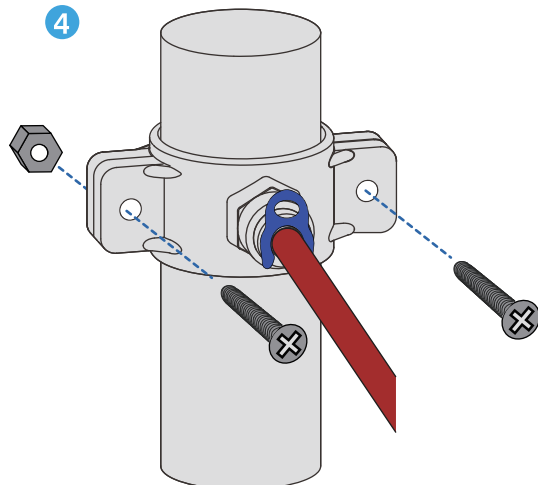

Connect the Tubes



Attention:

1. Make sure the tubes are fully inserted until you reach the mark on the tube. If the tubes are not fully inserted, no seal will be created and leakage will occur.
2. Always use the lock clips to secure the connections.
3. It's not recommended to cut the tubes. But if the tube is too long, cut it to a suitable length with a utility knife. Cut the tube squarely and cleanly. The cuts must be neat.

Connect the Inlet Water Tube

1. Identify the white inlet water tube which has been attached to the feed water adapter.
2. Insert the other end into the inlet water port, then gently pull the plastic ring of the port to leave a slot and secure the tube with a lock clip.

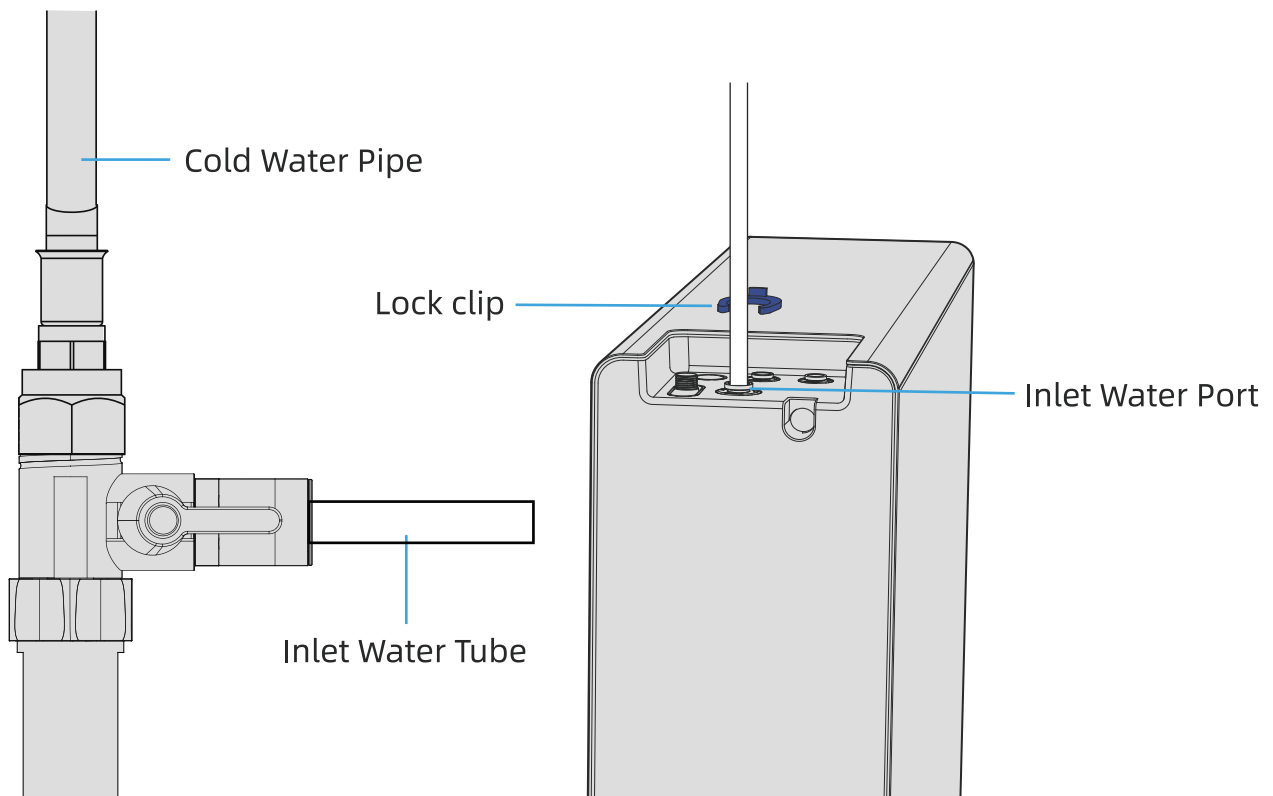

Connect the Filtered Water Tube

1. Connect one end of the white filtered water tube with the quick connector, then secure the connection with a lock clip.
2. Insert the other end into the filtered water outlet marked “Drinking Faucet” on the top of the system, then secure the tube with a lock clip.
3. Insert the faucet power cord into the Faucet Power port and tighten the nut.

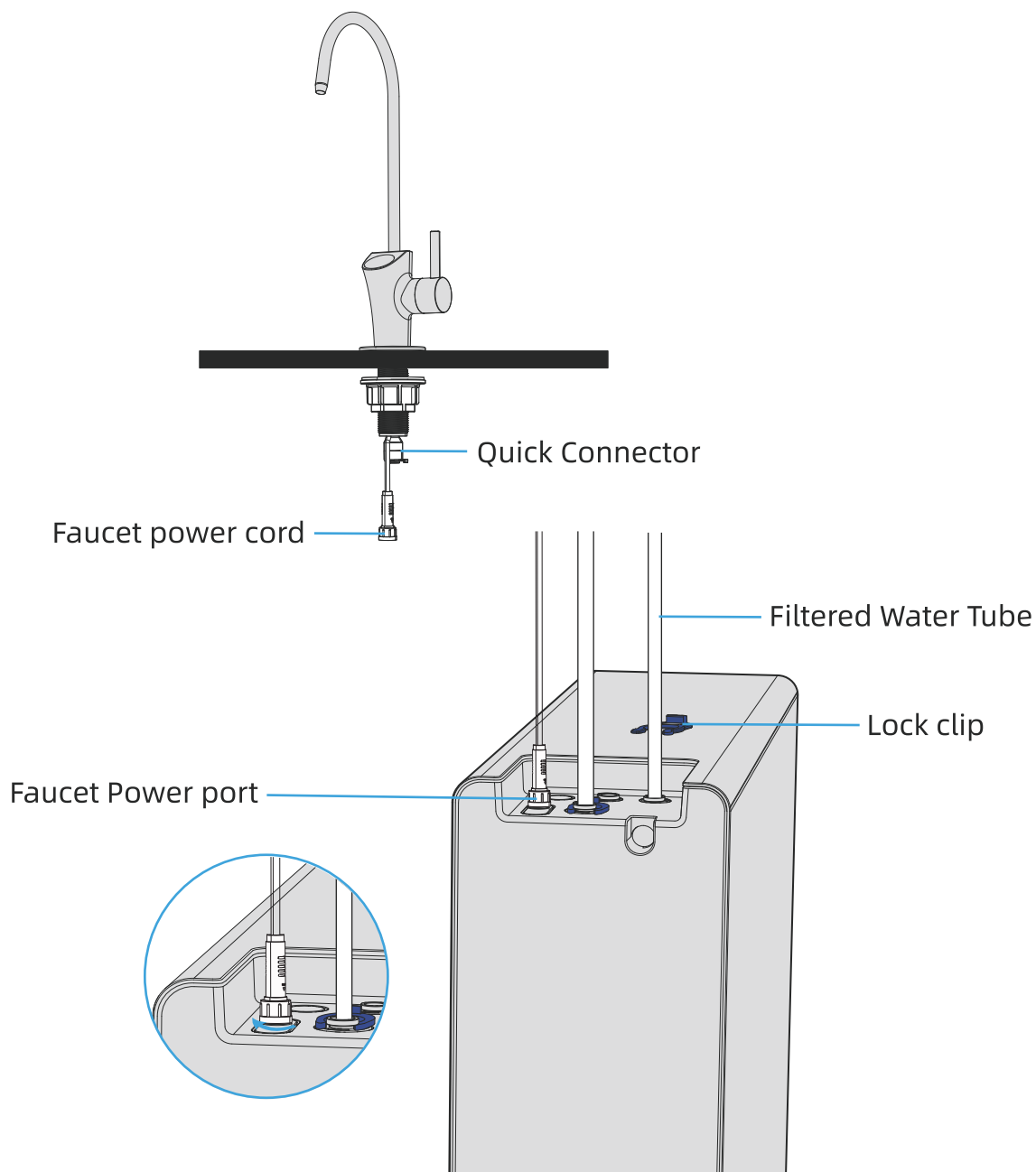

Connect the Waste Water Tube

1. Identify the red waste water tube which has been attached to the drain saddle.
2. Insert the other end into the waste water outlet marked “Drain” on the top of the system, then use a lock clip to secure the connection.

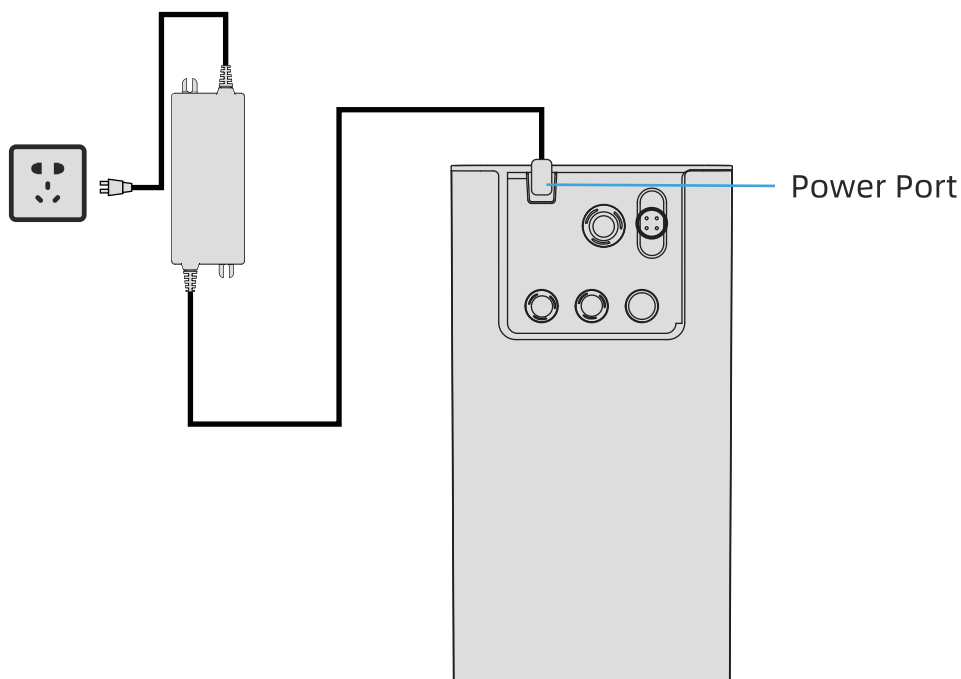
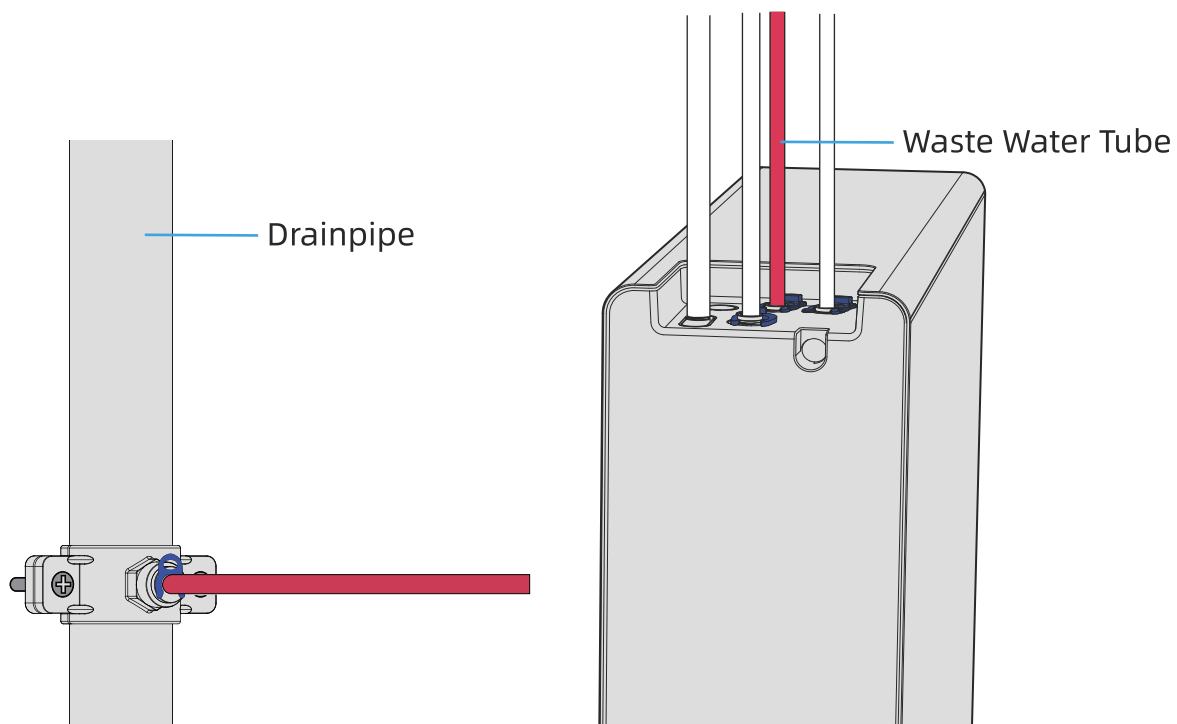

Start Up the System



1. Turn on the cold water supply valve and feeder water adapter. Check and make sure no water leakage at joints, fittings, valves, and tube connections.
2. Plug in the power adapter, the system starts flushing the RO membrane for 5 minutes. On the system housing, the filter indicators **(CF/CB/RO)** stay solid blue, while the water quality indicator flashes red.
3. Run the RO faucet for 30 minutes until the TDS value on the faucet screen is below 100, the water is drinkable. On the system housing, the filter indicators **(CF/CB/RO)** stay solid blue, while the water quality indicator flashes **(Blue: Good, purple: Fair, red: bad)** based on real-time inlet water quality.

Note: During flushing, the water is not drinkable. The flushing time accumulates, so if you stop the flushing early, the system will resume flushing when you open the RO faucet until it reaches a total of 30 minutes.



Flushing



Flushing
Complete

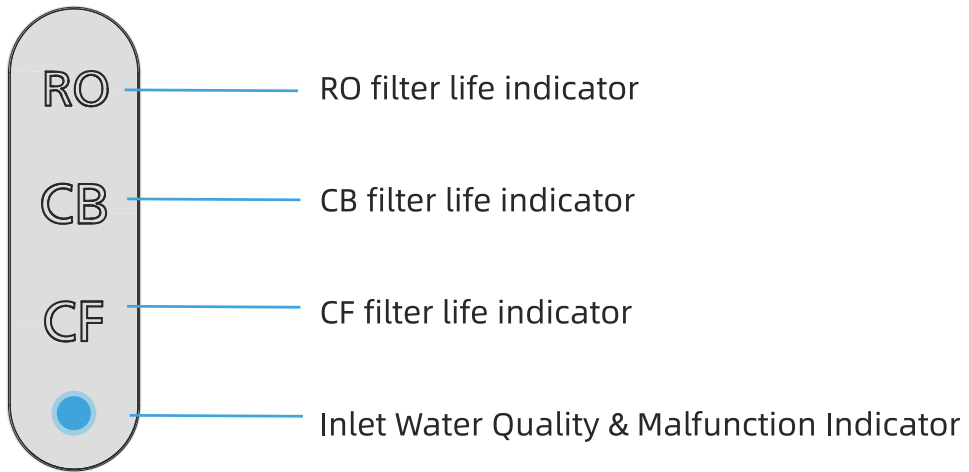

Filter Life Indicator

Monitor the filter indicator and replace the corresponding filter.

Indicator Color	Buzzer Status	Remaining Filter Life (Day)	Water Treatment Capacity (L)
Steady Blue	/	> 15	> 150
Steady Purple	Beeps 2 times when dispensing Water	≤15	≤150
Steady Red	Keeps beeping when dispensing Water	≤0	≤0

Inlet Water Quality Indicator

Indicator Color	Inlet Water Quality
Blue	Good
Purple	Fair
Red	Poor

RO Faucet Display

Machine Status	Display Status
The faucet is powered on	Show 888 for 2 seconds
The faucet is dispensing water	Show filtered water TDS value (Drinkable: TDS < 100)
Flushing the filters	
Machine Malfunction	E02 / E03 / E04 / E05

About Error Codes



Error Code	Malfunction Type	Malfunction Indicator	Filter Indicator	Solution
E02	Water Leakage	Flash red	RO filter indicator flashes blue.	1. Check all joints, fittings and tube connections to locate the leakage. The machine returns to normal operation if the problem is solved. 2. Make sure the filters are well-installed.
E03	Timeout	Flash red	CB filter indicator flashes blue.	Reconnect to the power supply.
E04	Frequent Start-stop	Flash red	CF & RO filter indicators flash blue.	Reconnect to the power supply.
E05	Low temperature	Flash red	CB & RO filter indicators flash blue.	Reconnect to the power supply.

Filter Replacement Guide



Filter	Filter Life
RO Filter	Up to 24 Months
CB Filter	Up to 12 Months
CF Filter	Up to 12 Months

Notes:

1. The filter life is for reference only, as the filter life varies with the source water quality and usage frequency.
2. To ensure the quality of drinking water, please monitor the filter indicators and replace the corresponding filter.
3. For continued water filtration and optimum system performance, only use genuine SMONET filter replacements.

How to Replace the Filters

1. Twist off the old filter in a counterclockwise direction.
2. Remove the packaging from the new filter.
3. Insert the new filter into the corresponding slot and twist it clockwise to secure it in place.
4. After replacement, reset the filter life indicator first and then flush the filter.

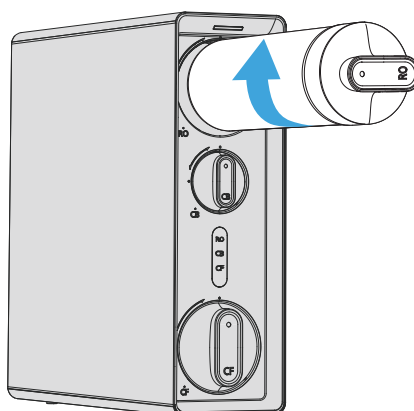
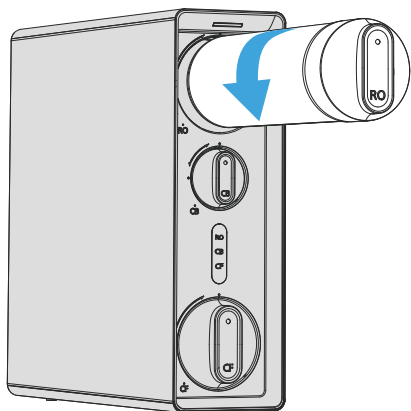

How to Reset the Filter Life Indicator

To reset the filter life, touch and hold the red filter indicator for 5 seconds, it turns solid blue and the buzzer beeps once.

Note: Each filter's life indicator cannot be reset simultaneously and requires individual resetting one by one.

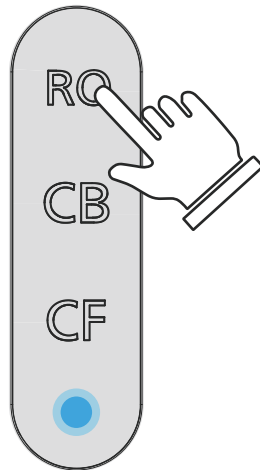

- Touch and hold for 5s

How to Flush the New Filters after Replacement

- After replacing the filter and resetting the corresponding filter indicator:

CF filter: Turn on the RO faucet to flush for 5 minutes, the water quality indicator flashes red.

CB filter: Turn on the RO faucet to flush for 15 minutes, the water quality indicator flashes (Blue: good, Purple: fair, Red: poor) based on real-time inlet water quality.

RO filter: Turn on the RO faucet to flush for 30 minutes, the water quality indicator flashes (Blue: good, Purple: fair, Red: poor) based on real-time inlet water quality.



Problems	Solutions
How to connect/disconnect the tubes or quick connector?	Refer to the tips before installation (Page 5).
Machine not working.	<ol style="list-style-type: none">1. Securely plug the power adapter into the power socket, or try another power socket.2. Contact us if the problem still exists.
System halted.	Unplug the power adapter and plug it in again.
Machine alarms.	<ol style="list-style-type: none">1. If the filter life is exhausted, replace the filter and reset the filter life indicator.2. Unplug the power adapter and plug it in again.
No water out.	<ol style="list-style-type: none">1. If the filter life is exhausted, replace the filter and reset the filter life indicator.2. Contact us if the problem still exists.
Small amount of water.	<ol style="list-style-type: none">1. If the water pressure is low, increase the water pressure.2. Check the filter life indicator to confirm which filter needs to be replaced and replace immediately.
Bad water taste	<ol style="list-style-type: none">1. If the pipeline or joint ages, replace the pipeline or joint.2. Check the tubes installation. Make sure the waste water tube is not connected with RO faucet.3. Make sure the filters are well-installed. Check the filter life indicator to confirm which filter needs to be replaced and replace it immediately.

Specifications



Model	E600WA
Product Size (L*W*H)	46.2*14*44.3 (cm) / 18.2*5.5*17.4 (inch)
Feed Water Temperature	41-100 °F / 5-38 °C
Feed Water Pressure	0.1-0.6 Mpa
Feed Water Requirement	Municipal Tap Water
Power Supply	Input:AC 100-240V, 50/60Hz
Rated Power	84W
Water Flow	≥1.58L/min
Applicable Ambient Temperature	39-104 °F/ 4-40 °C

smonet[®]

Your Safety is Our Priority